

PL250 Portable Journal Lathe

PL250 Portable Journal Lathe is a portable shaft turning lathes, Mainly used in machining the outside diameter of a shaft to bring it within the required specification for concentricity, surface finish and circularity tolerance. Can work both horizontally and vertically. And also can accurately machining bearing journals and other circular surfaces.

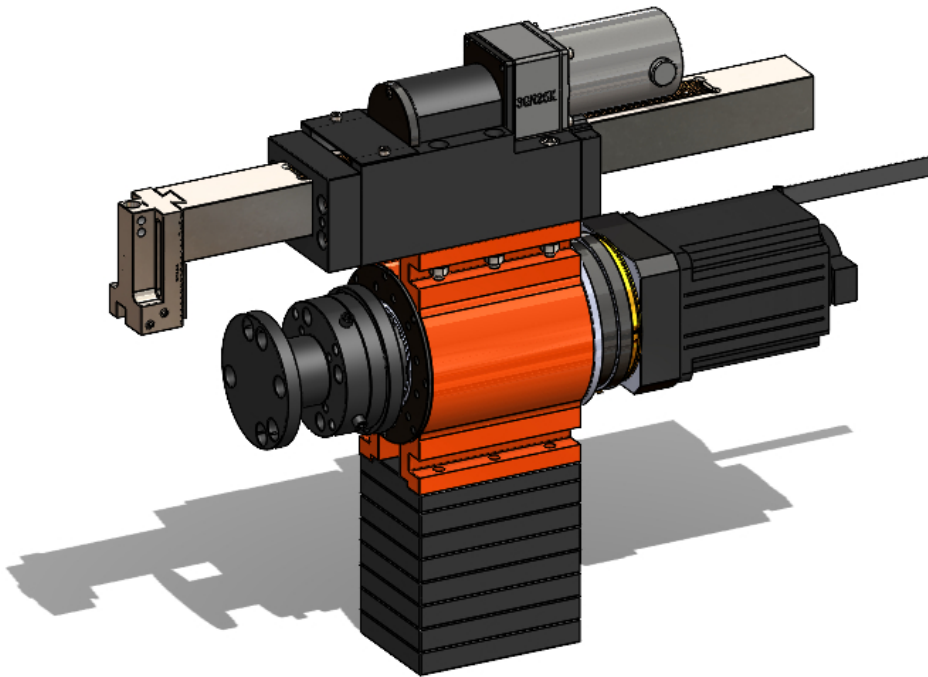

Technical Parameter

:

- Working range: 80mm-230mm
- Max working length: 300mm
- RPM: 0-150rpm
- Rated power: 1.8KW
- Speed mode: Stepless speed
- Drive mode: Servo motor
- Ra: R3.2
- Ovality tolerance: 0.02
- Taper tolerance: 200/0.03
- Max cutting thickness: 1.5mm

PL250 Portable Journal Lathe

